

PROJECT NAME: STOCK DOORS CUSTOMER: _____

APPLICATION: INTERIOR EXTERIOR FINISH: PRIME PAINT (STD. GREY) NB JOB #: _____

DOUBLE-LEAF DOOR SPECIFICATIONS

DOOR No.	DOOR SWING (ACTIVE LEAF)	WINDOW OPTION		INSTALLATION OPTION	CLEAR OPENING WIDTH	CLEAR OPENING HEIGHT	ROUGH OPENING WIDTH	ROUGH OPENING HEIGHT	WALL THICKNESS
		ACTIVE	INACTIVE						
SD-1	RHR	FLUSH	FLUSH	A	108.00"	132.00"	114.00"	135.25"	4.00"

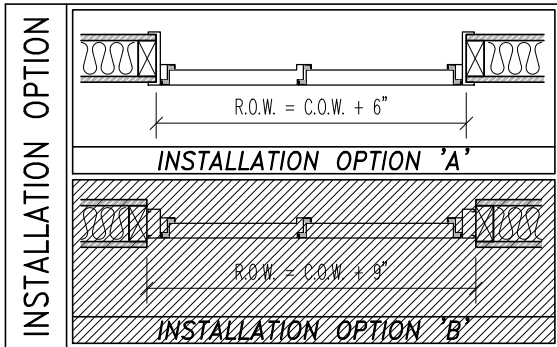
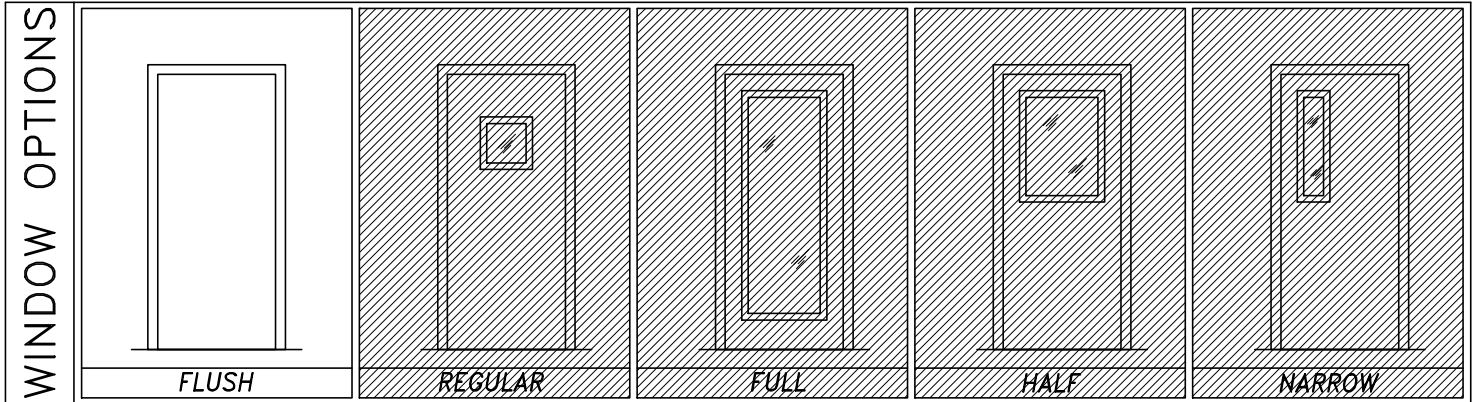
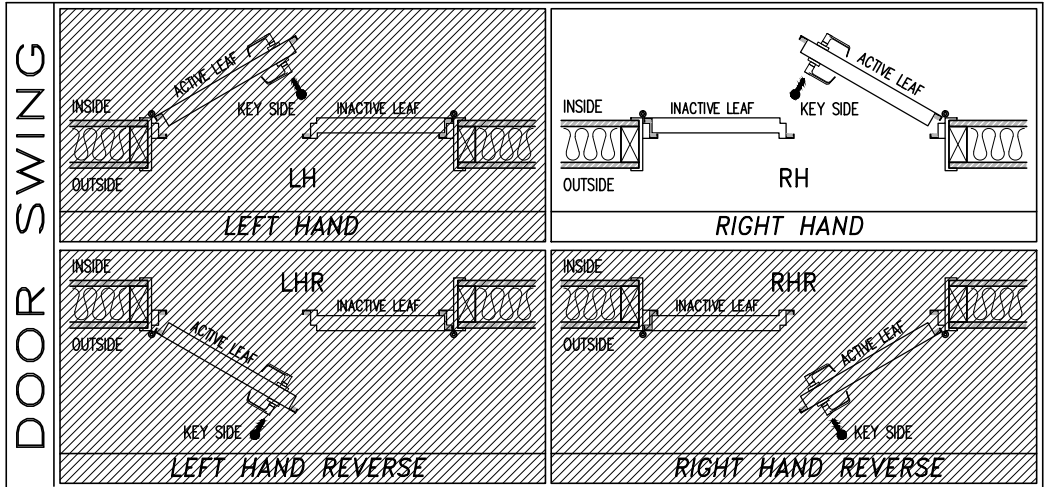
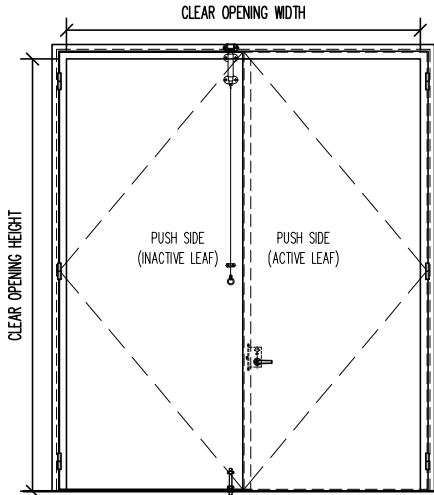

HARDWARE SCHEDULE		
HINGES	MFG. STANDARD CAM-LIFT HINGES (QTY. (3) PER LEAF / FINISH: US320)	QTY. 6
HINGE DAMPER	SEALTIGHT BACKER PAD	QTY. 6
PASSAGE SET	SCHLAGE L9010-03A-626 MORTISED PASSAGE SET	QTY. 1
DOOR CLOSER	LCN 4040XP-REG HEAVY-DUTY DOOR CLOSER (FACTORY PREPPED @ PULL SIDE / FINISH: AL)	QTY. 1
SPRING BOLT (TOP)	MC#1235A11 SPRING BOLT W/ 60" CHAIN RELEASE (MOUNTED @ TOP OF INACTIVE LEAF / FINISH: US260)	QTY. 1
SLIDE BOLT (BOT.)	HAGER #275D 8" SLIDE BOLT (MOUNTED @ BOTTOM OF INACTIVE LEAF / FINISH: US260)	QTY. 1
THRESHOLD	ONE-PIECE 1/4" ALUMINUM SILL PLATE	QTY. 1
DOOR BOTTOM	MFG. STANDARD TEFLON COATED COMPRESSION SEAL	QTY. 2
HD/JMB/ASTRAGAL SEALS	MFG. STANDARD DOUBLE MAGNETIC SEALS	as req'd

NOTES: 1.) SEE SHEET DS-5 FOR INSTALLATION DETAILS

<p>STC-52 DOUBLE-LEAF DOOR SPECIFICATIONS</p>	PROJECT: STOCK DOORS		TYPE:
	SUBMITTED BY:	DATE:	ISSUE:
	APPROVED BY:	DATE:	PROJECT No.:
	PROJ. MGR.	SHEET: DS-X	

Noise Barriers, LLC
 2001 Kelley Court
 Libertyville, IL 60048
 Phone: (847) 843-0500
 Fax: (847) 843-0501
www.noisebarriers.com