

PROJECT NAME: \_\_\_\_\_ CUSTOMER: \_\_\_\_\_

APPLICATION:  INTERIOR  EXTERIOR FINISH: \_\_\_\_\_ NB JOB #: \_\_\_\_\_

## STC-54 DOUBLE-LEAF DOOR SUBMITTAL

DOOR No.	DOOR SWING (ACTIVE LEAF)	WINDOW OPTION		INSTALLATION OPTION	CLEAR OPENING WIDTH	CLEAR OPENING HEIGHT	ROUGH OPENING WIDTH	ROUGH OPENING HEIGHT	WALL THICKNESS
		ACTIVE	INACTIVE						

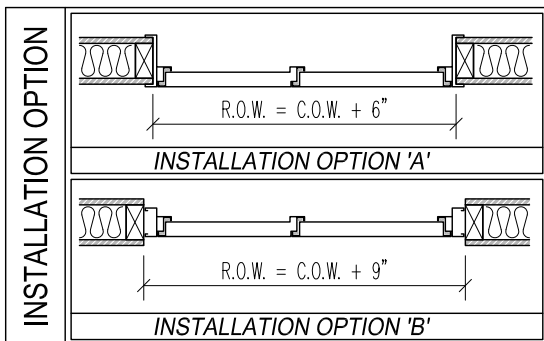
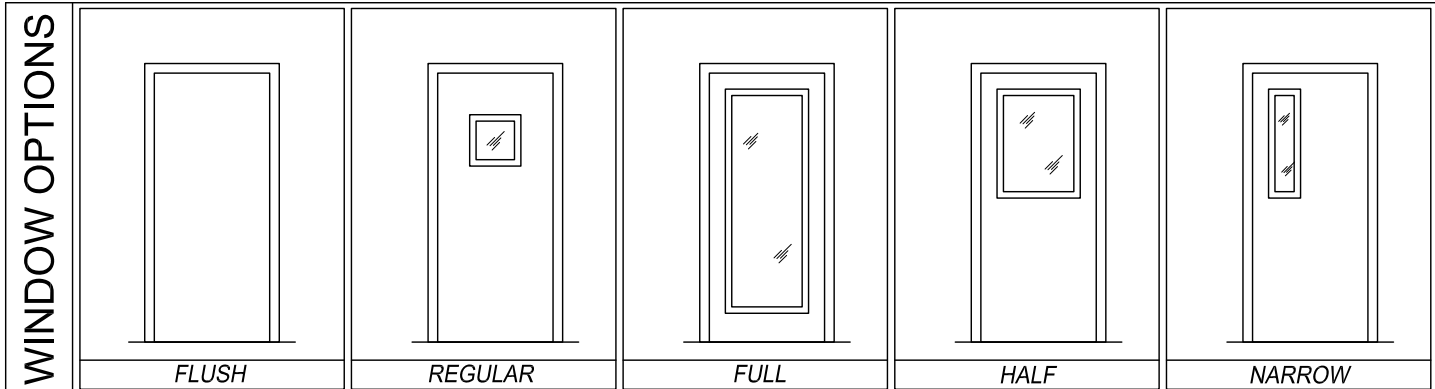
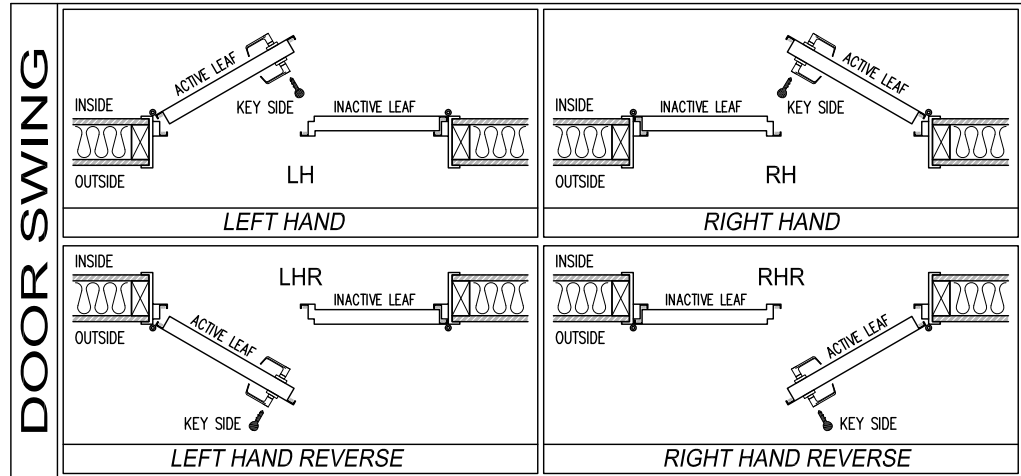
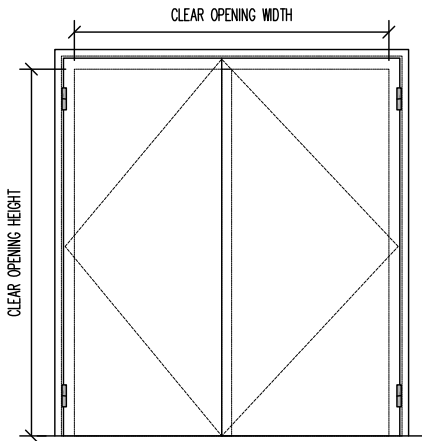

HARDWARE SCHEDULE		
HINGES	MFG. STANDARD CAM-LIFT HINGES	QTY.
DOOR BOTTOM	MFG. STANDARD TEFLON COATED COMPRESSION SEAL	QTY. 2
HD/JMB/ASTRAGAL SEALS	MFG. STANDARD DOUBLE MAGNETIC SEALS	as req'd

NOTES: \_\_\_\_\_

<h3>STC-54 DOUBLE-LEAF DOOR SPECIFICATIONS</h3>	PROJECT:		TYPE:	
	SUBMITTED BY:		DATE:	ISSUE:
	APPROVED BY:		DATE:	PROJECT No.:
	PROJ. MGR.	SHEET:		

**Noise Barriers, LLC**  
 201 Kelley Court  
 Libertyville, IL 60048  
 Phone: (847) 843-0500  
 Fax: (847) 843-0501  
[www.noisebarriers.com](http://www.noisebarriers.com)