

PROJECT NAME: \_\_\_\_\_ CUSTOMER: \_\_\_\_\_

APPLICATION:  INTERIOR  EXTERIOR FINISH: \_\_\_\_\_ NB JOB #: \_\_\_\_\_

## DOOR SPECIFICATIONS

DOOR No.	DOOR SWING	WINDOW OPTION	INSTALLATION OPTION	CLEAR OPENING WIDTH	CLEAR OPENING HEIGHT	ROUGH OPENING WIDTH	ROUGH OPENING HEIGHT	WALL THICKNESS

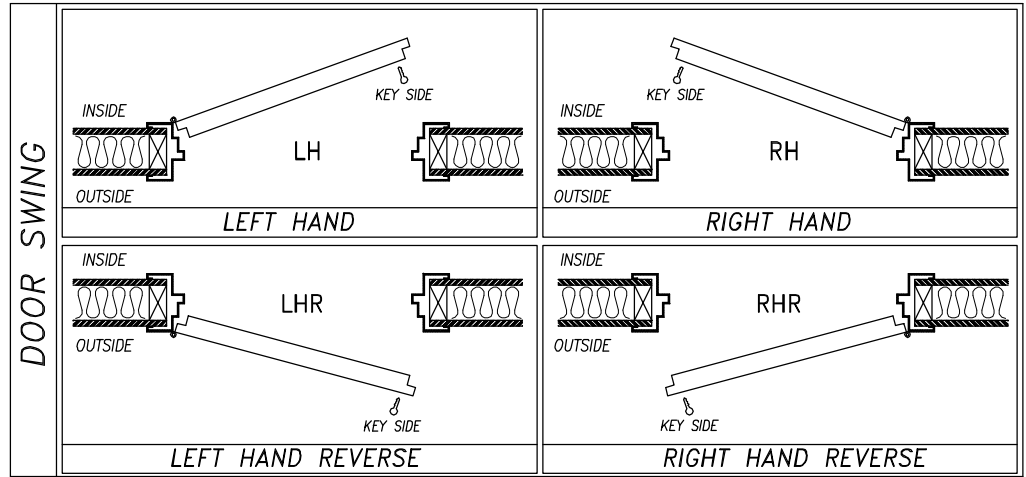
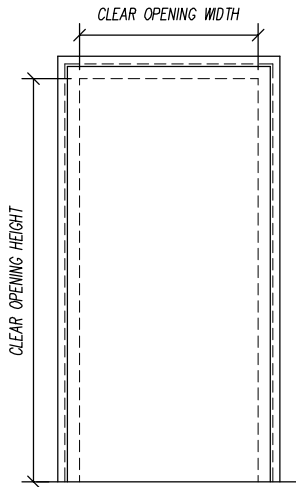

### WINDOW OPTIONS

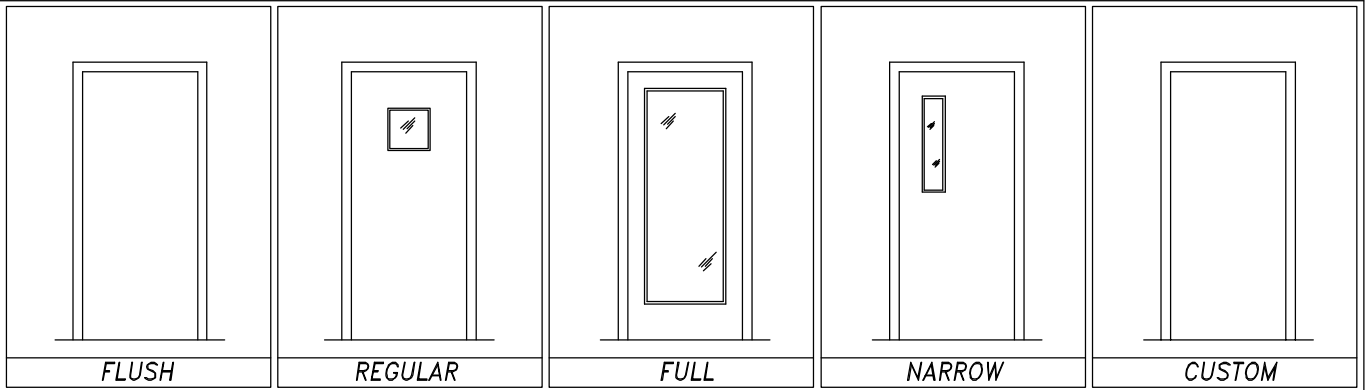

### INSTALLATION OPTION

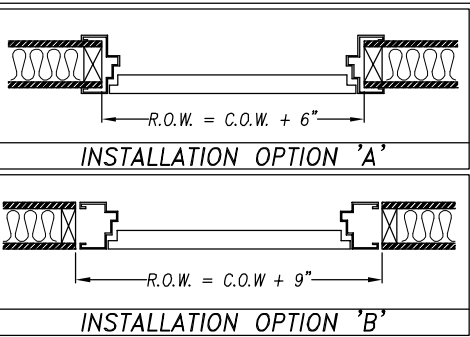

## HARDWARE SCHEDULE

HINGES	MFG. STANDARD CAM-LIFT HINGES (QTY. (2) PER LEAF)
PUSH/PULL HANDLE	TRIMCO 1195-2 PUSH/PULL HANDLE (QTY. (2), BACK-TO-BACK, US260 FINISH)
THRESHOLD	ONE-PIECE 1/4" ALUMINUM SILL PLATE
DOOR BOTTOM	MFG. STANDARD TEFLON COATED COMPRESSION SEAL
HD/JMB/ASTRAGAL SEALS	MFG. STANDARD DOUBLE MAGNETIC SEALS

NOTES: \_\_\_\_\_

**STC-48  
SL-DOOR  
SPECIFICATIONS**

PROJECT:	TYPE:	
SUBMITTED BY:	DATE:	ISSUE:
APPROVED BY:	DATE:	PROJECT No.:
	SHEET:	

**Noise Barriers, LLC**  
 2001 Kelley Court  
 Libertyville, IL 60048  
 Phone: 847-843-0500  
 Fax: 847-843-0501  
 www.noisebarriers.com