

PROJECT NAME: \_\_\_\_\_ CUSTOMER: \_\_\_\_\_

APPLICATION:  INTERIOR  EXTERIOR FINISH: \_\_\_\_\_ NB JOB #: \_\_\_\_\_

## DOUBLE-LEAF DOOR SPECIFICATIONS

DOOR No.	DOOR SWING (ACTIVE LEAF)	WINDOW OPTION		INSTALLATION OPTION	CLEAR OPENING WIDTH	CLEAR OPENING HEIGHT	ROUGH OPENING WIDTH	ROUGH OPENING HEIGHT	WALL THICKNESS
		ACTIVE	INACTIVE						

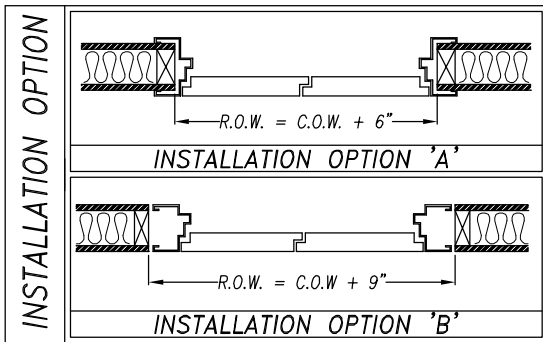
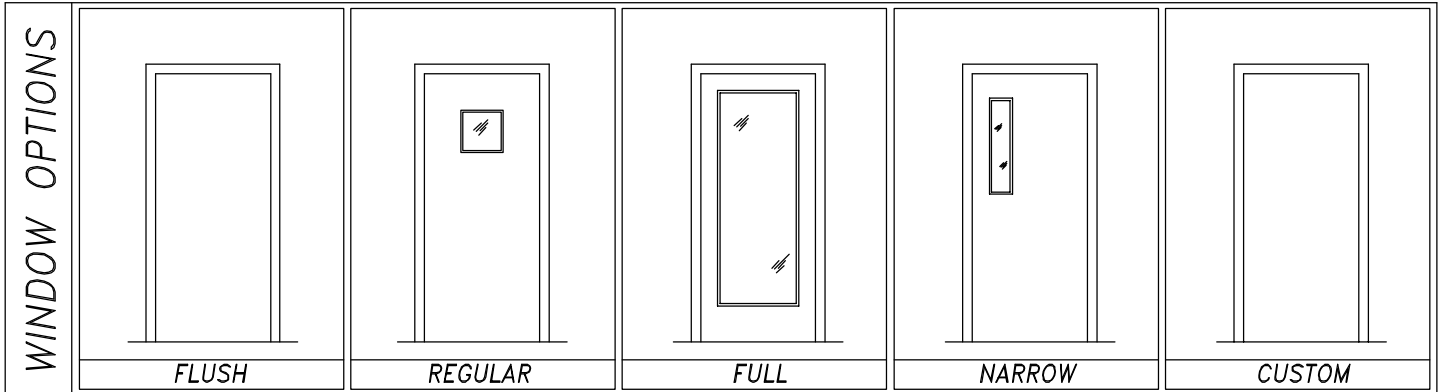
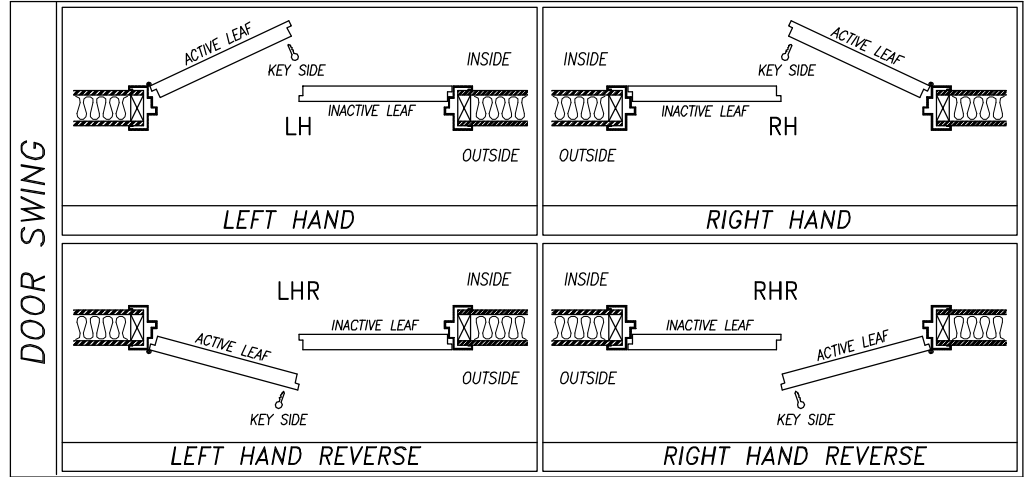
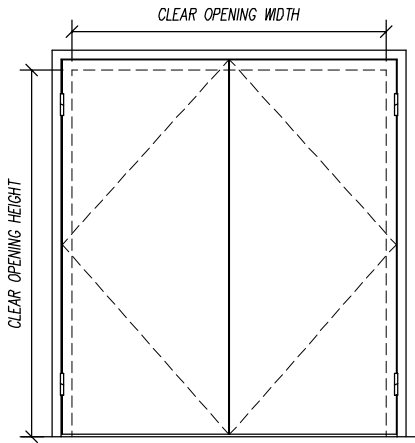

<b>HARDWARE SCHEDULE</b>	
HINGES	MFG. STANDARD CAM-LIFT HINGES (2 PER LEAF)
SURFACE BOLTS	MFG. STANDARD SURFACE MOUNTED SLIDE BOLTS (TOP & BOT. INACTIVE LEAF)
DOOR BOTTOM	MFG. STANDARD TEFLON COATED COMPRESSION SEAL
HEAD/JAMB SEALS	MFG. STANDARD DOUBLE MAGNETIC SEALS

NOTES: \_\_\_\_\_

<b>STC-45 DL-DOOR SPECIFICATIONS</b>	PROJECT:	TYPE:	
	SUBMITTED BY:	DATE:	ISSUE:
	APPROVED BY:	DATE:	PROJECT No.:
	SHEET:		

**Noise Barriers, LLC**  
 2001 Kelley Court E  
 Libertyville, IL 60048  
 Phone: 847-843-0500  
 Fax: 847-843-0501  
 www.noisebarriers.com